

KINGS COUNTY COMMUNITY DEVELOPMENT AGENCY TYPICAL PATIO ROOF

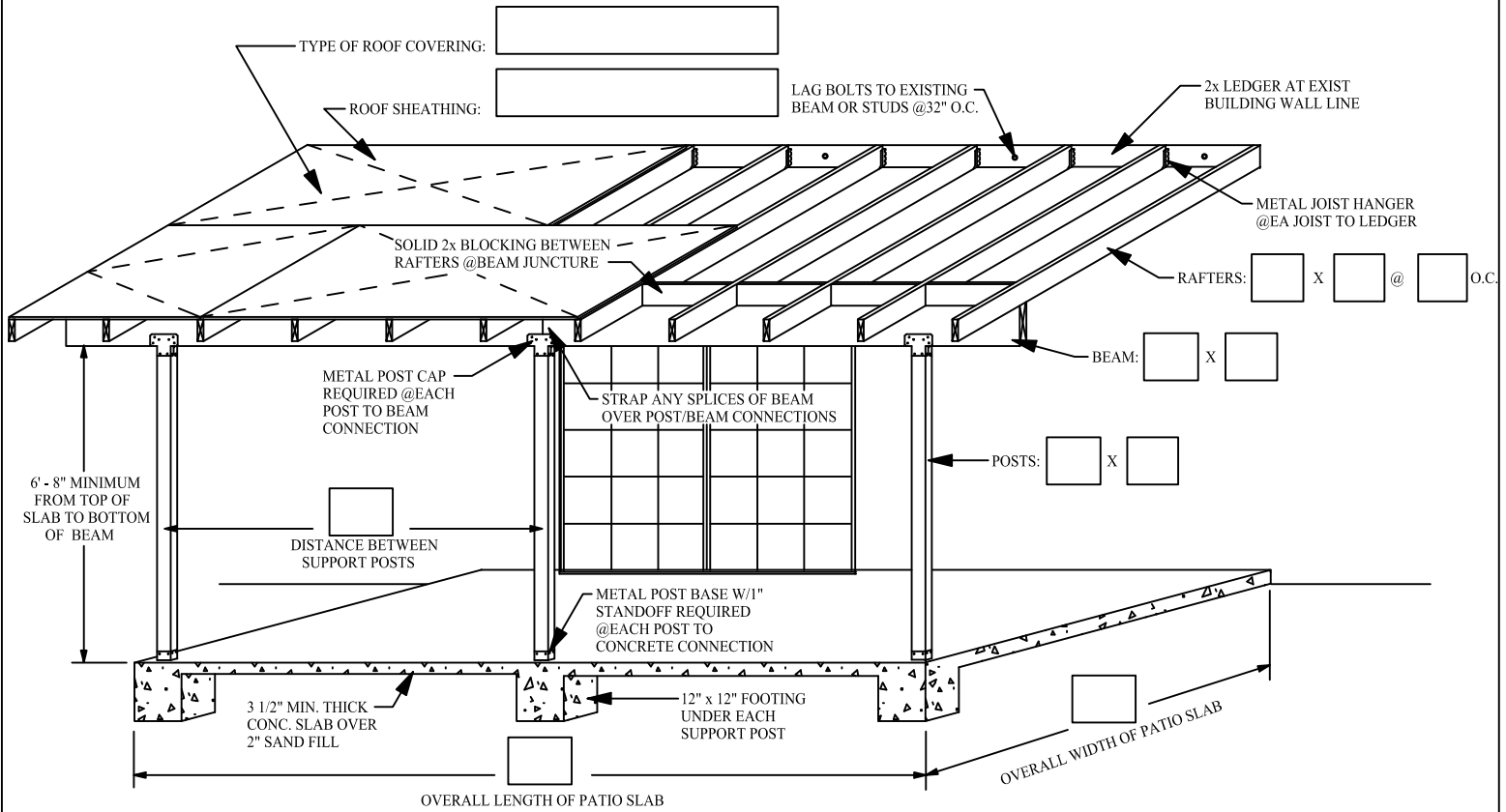

TYPICAL PATIO CONSTRUCTION

CONSTRUCTION NOTES:

- 1.) PATIO RAFTERS ARE NOT TO BE ATTACHED TO EXISTING FASCIA.
- 2.) THIS COVER IS NOT DESIGNED TO BE ENCLOSED.
- 3.) CONCRETE SLAB TO BE MINIMUM 3 1/2" THICK AND MUST MEET MINIMUM OF 2500 PSI STRENGTH.
- 4.) ALL LUMBER TO BE DOUGLAS FIR #2 GRADE OR BETTER.
- 5.) ROOF SHEATHING NAILED W/8d NAILS @6" O.C AT ALL PANEL EDGES AND @12" O.C. IN FIELD.
- 6.) ROOFING MUST BE A MINIMUM OF:
 - a.) UNDER 2:12 PITCH: HOT MOPPED W/2 LAYERS OF 15LB FELT UNDERLAYMENT, 1 - 60 LB CAP SHEET AND 1 LAYER OF 90 LB MINERAL SURFACE TOP CAP OR AN APPROVED SELF-ADHERING ROOFING PRODUCT.
 - b.) OVER 2 1/2:12 PITCH: 2 LAYERS OF 15 LB FELT UNDERLAYMENT WITH COMPOSITION ASPHALT SHINGLES.
- 7.) METAL OR TRANSLUCENT ROOF PANELS ACCEPTABLE WHEN INSTALLED PER MANUFACTURERS SPECIFICATIONS.

RAFTER SPAN TABLE			
RAFTER SIZE	SPACING @CENTERS	MAX SPAN DOUG FIR #1	MAX SPAN DOUG FIR #2
2 x 6	12"	17'- 4"	16'- 10"
	16"	15'- 4"	14'- 7"
	24"	12'- 6"	11'- 11"
2 x 8	12"	22'- 5"	21'- 4"
	16"	19'- 5"	18'- 5"
	24"	15'- 10"	15'- 1"

BEAM SPAN TABLE	
DISTANCE BETWEEN SUPPORT POSTS CENTER TO CENTER	MINIMUM BEAM SIZE DIMENSIONS
5 FEET	4" x 4"
7 FEET	4" x 6"
9 FEET	4" x 8"
11 FEET	4" x 10"
13 FEET	4" x 12"

KINGS COUNTY COMMUNITY DEVELOPMENT AGENCY TYPICAL PATIO ROOF

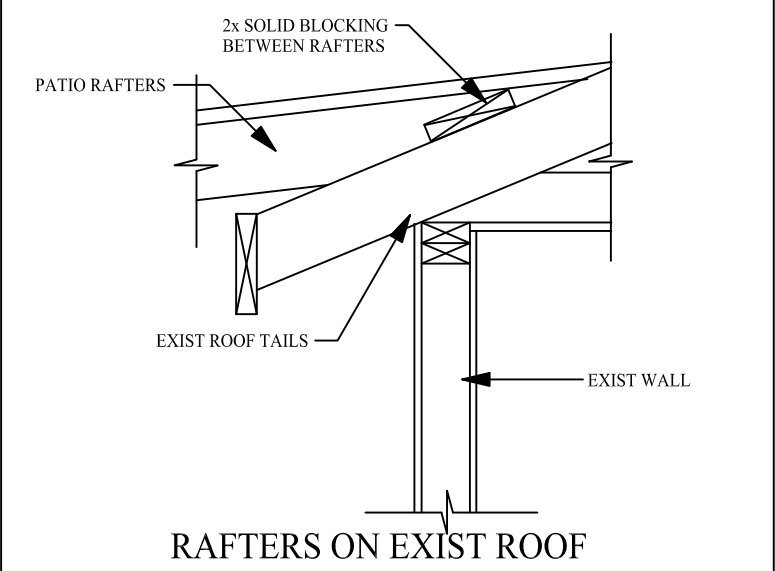
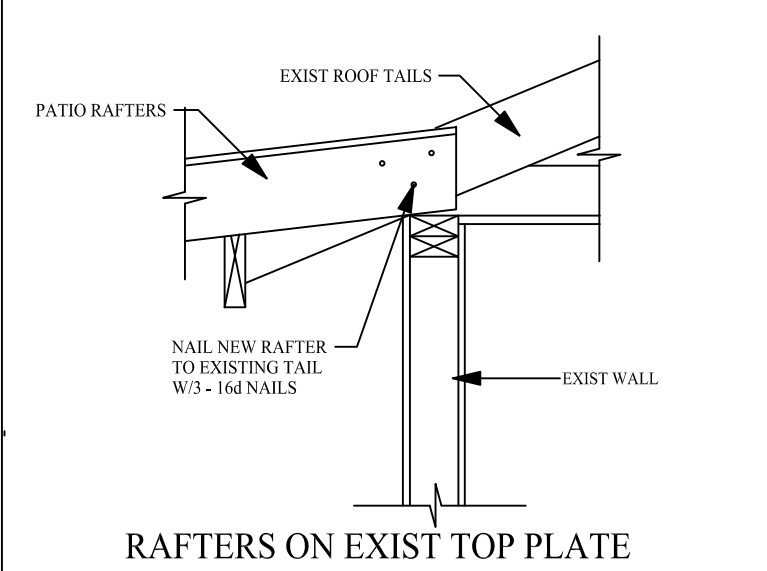
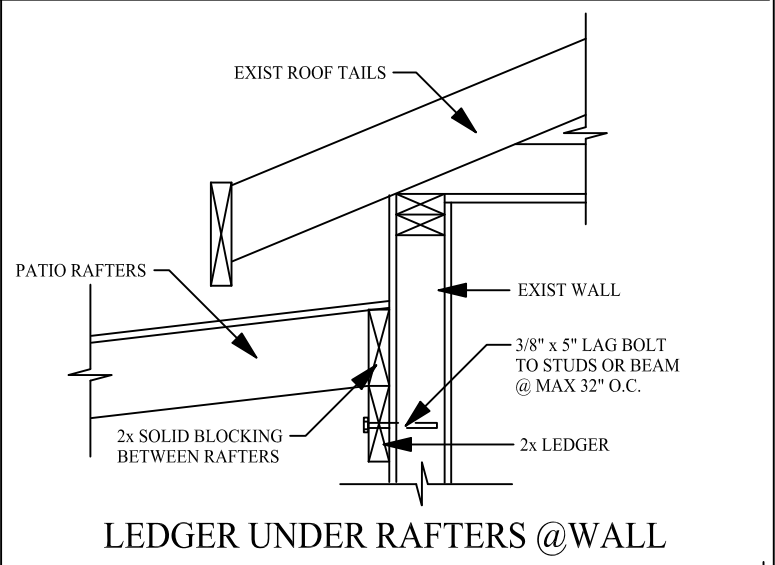
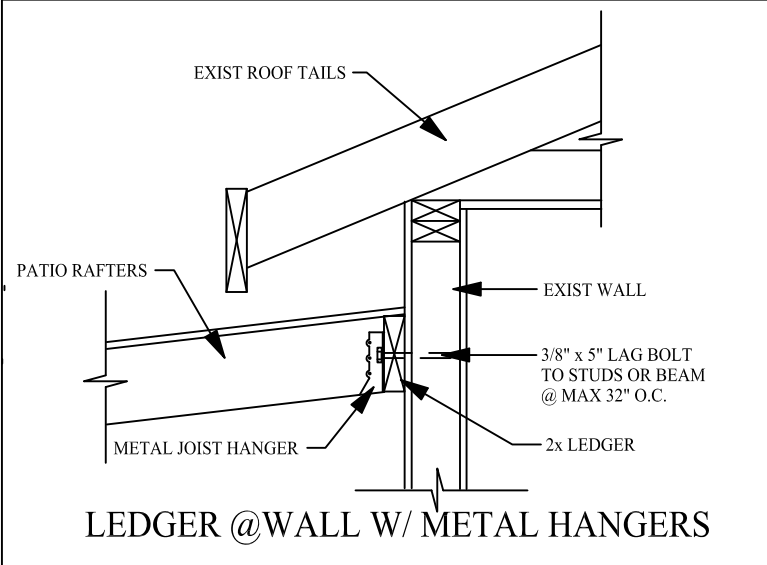

POST ANCHOR

'SIMPSON' AB44, 'USP' PA44
OR EQUAL

POST CAP

'SIMPSON' AC44, 'USP' PBS44
OR EQUAL

JOIST HANGER

'SIMPSON' LU26, 'USP' JUS26
OR EQUAL